

# AP 03 - SAD 03

## SUPRAFETE UTILE:

- 1 - Spatiu birouri: 40,54 mp
- 2 - Depozitare 03: 4,61 mp
- 3 - Grup sanitar 03: 3,91mp

Total Su: 49,06 mp

## SUPRAFETE CONSTRUITE:

Total Sc: 59,49 mp

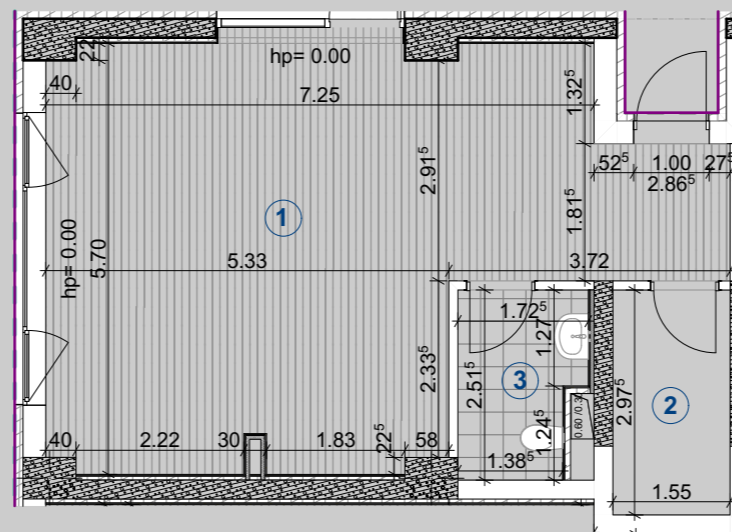

AP 03 -  
SAD 03

Parter

